

SURVEY DIAGRAM

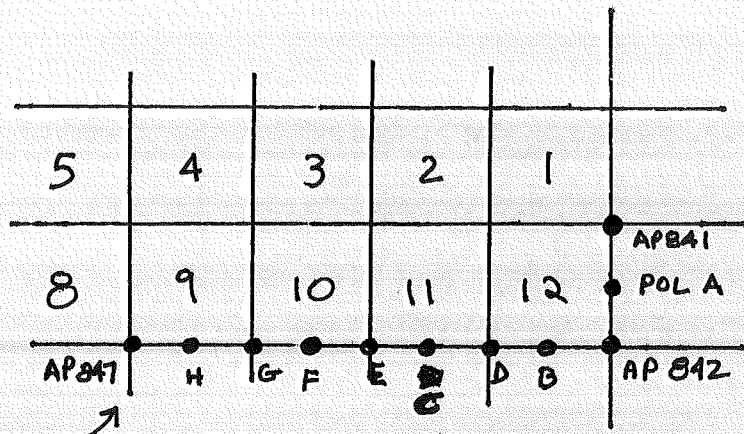

POINTS ARE NOT
ON SEC. CORNERS. LOC.

R7E R8E
T20S

B, D, C, E order
is correct...

LEGEND

○ = Corner having information on form 7100-52 in this file.

FILING INSTRUCTIONS

Draft tract diagram in space at left.
 File 7100-52 card record in numerical
 sequence behind tract file guide as the
 data are obtained and recorded. Show
 by above symbol, on the tract diagram
 those corners having data in this file.

USDA-FOREST SERVICE

Index

File No. _____

Three Sisters W.A. 3-PTS 3

CORNER RECORD (SEARCH)

(Ref. FSM 7151.4)

Tract or

000983

Cor.

Pol A

Survey No. _____

No. _____

T 20 S. R. 7 E.

R.D. Bond

County Deschutes

Merid. WILLAMETTE

N.F. DESCHUTES

State OREGON

CORNER DIAGRAM

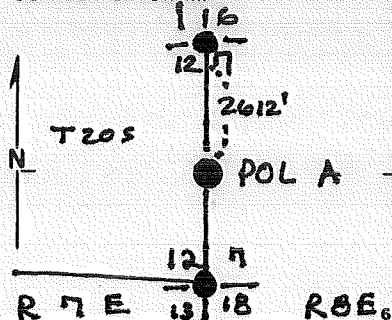

DESCRIBE CORNER MONUMENT FOUND

None Set

DESCRIBE BEARING TREES OR OTHER OFFICIAL ACCESSORIES FOUND

None Set

PHOTO IDENTIFICATION DATA

Photo No. _____

Filed At. _____

Object Ident. _____

Ident. By _____

Signature

DESCRIBE CORNER LOCATION RELATIVE TO NEAR-BY FEATURES, ALSO HOW TO REACH CORNER

2612' south ~~set~~ of $\frac{116}{1217}$ Sect. Corner

PLANE COORDINATE POSITION DATA

State _____ Zone _____

X _____

Y _____

Estab. By _____

Agency

Signature Walt Muller

Title PLS

Division CS

Headquarters SO

Date 9/26

D-7100-52 (10/78)

CORNER RECORD (PERPETUATION)

MONUMENT: DESCRIBE NEW MONUMENT SET, OR WORK DONE TO PRESERVE EXISTING MONUMENT

Set By GPS Methods a capped rebar rising 2"

3SW
POL. A
PLS 2111
1996

MONUMENT
STAMPED
9

ACCESSORIES DESCRIBE NEW BT'S WITNESS OBJECTS ETC. ESTABLISHED, OR WORK DONE TO PRESERVE EXISTING EVIDENCE

11" Hemlock brs S.80°E @ 15.6' mkd 3SW POL.A BT
5" " " N77W @ 13.2' " " X BT

10

Work Done By Walt Nutter Title PLS Date 9/96 State Registration No. 2111
or Agency
Certified Cor. Record Prepared? Yes No Filed At: Des. Court Date 2/27/97

11

REMARKS

12

Index File No. T. S., R. E., W. M. Tract or Surv. No. Cor. POL A

13

USDA-FOREST SERVICE

Index
File No. _____

Three Sisters W.A. 4-PTS 9

CORNER RECORD (SEARCH)

(Ref. FSM 7151.4)

Tract or
Survey No. _____

000983

Cbr. No. ~~10~~ Pol A

T 20 S. R. 7 E.

R.D. Bond

County Deschutes

Merid. WILLAMETTE

N.F. DESCHUTES

State OREGON

CORNER DIAGRAM

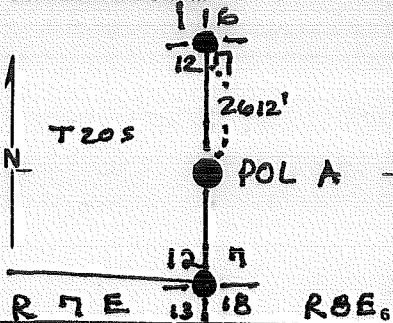

DESCRIBE CORNER MONUMENT FOUND

None Set

DESCRIBE BEARING TREES OR OTHER OFFICIAL ACCESSORIES FOUND

None Set

PHOTO IDENTIFICATION DATA

Photo No. _____
Filed At. _____
Object Ident. _____
Ident. By _____
Signature

DESCRIBE CORNER LOCATION RELATIVE TO NEAR-BY FEATURES, ALSO HOW TO REACH CORNER

2612' south ~~set~~ of $\frac{116}{12.7}$ Sect. Corner

PLANE COORDINATE POSITION DATA

State _____ Zone _____
X _____
Y _____
Estab. By _____
Agency

Signature Walt Miller

Title PLS

Division CS

Headquarters SO

Date 9/96

D-7100-52 (10/78)

CORNER RECORD (PERPETUATION)

MONUMENT: DESCRIBE NEW MONUMENT SET, OR WORK DONE TO PRESERVE EXISTING MONUMENT

Set By GPS Methods a capped rebar rising 2"

3SW
 POL. A
 PLS 2111
 1996

MONUMENT
 STAMPED

ACCESSORIES DESCRIBE NEW BT'S WITNESS OBJECTS ETC. ESTABLISHED, OR WORK DONE TO PRESERVE EXISTING EVIDENCE

11" Hemlock brs S.80°E @ 15.6' mkd 3SW POL.A BT
 5" " " N77W @ 13.2' " X BT

10

Work Done By Walt Muller Title PLS Date 9/96 State Registration No. 2111
 or Agency _____
 Certified Cor. Record Prepared? Yes No Filed At: Des. Court Date 2/27/97

11

REMARKS

12

Index File No. T. S., R. E., W. M. Tract or Surv. No. Cor. POL A

13

USDA-FOREST SERVICE

Index
File No. _____

Three Sisters W.A. 3-PTS 3

CORNER RECORD (SEARCH)

(Ref. FSM 7151.4)

Tract or Survey No. 000983

Cor. No. ~~1~~ Pol A

T 20 S. R. 7 E.

R.D. Bond

County Deschutes

Merid. WILLAMETTE

N.F. DESCHUTES

State OREGON

CORNER DIAGRAM

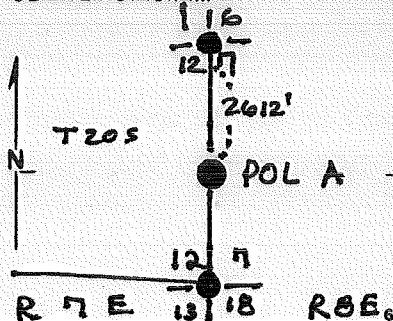

DESCRIBE CORNER MONUMENT FOUND

None Set

DESCRIBE BEARING TREES OR OTHER OFFICIAL ACCESSORIES FOUND

None Set

PHOTO IDENTIFICATION DATA

Photo No. _____

Filed At. _____

Object Ident. _____

Ident. By _____

Signature

DESCRIBE CORNER LOCATION RELATIVE TO NEAR-BY FEATURES, ALSO HOW TO REACH CORNER

2612' south ~~set~~ of $\frac{116}{1217}$ Sect. Corner

PLANE COORDINATE POSITION DATA

State _____ Zone _____

X _____

Y _____

Estab. By _____

Agency

Signature Walt Miller

Title PLS

Division CS

Headquarters SO

Date 9/96

D-7100-52 (10/78)

CORNER RECORD (PERPETUATION)

DESCRIBE NEW MONUMENT SET, OR WORK DONE TO PRESERVE EXISTING MONUMENT

GPS Methods a capped rebar rising 2"

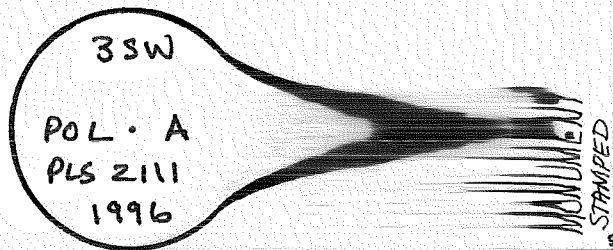

DESCRIBE NEW BT'S WITNESS OBJECTS ETC. ESTABLISHED, OR WORK DONE TO PRESERVE EXISTING EVIDENCE

lock brs S.80°E @ 15.6' mkd 3SW POL·A BT
" N77W @ 13.2' " X BT

Walt Muller Title

PLS

Date 9/96

State Registration No. or Agency

2111

Record Prepared

Yes

No

Filed At:

Des. Count

Date

2/27/97

REMARKS

T.

S., R.

E., W. M.

Tract or Surv. No.

Cor. POL

A

USDA-FOREST SERVICE

Index

File No. _____

Three Sisters W.A. 3-PTS 7

CORNER RECORD (SEARCH)

(Ref. FSM 7151.4)

Tract or

000983

Cor.

No.

Pa A

T 20 S. R. 7 E.

R.D. Bond

County

Deschutes

Merid. WILLAMETTE

N.F. DESCHUTES

State

OREGON

CORNER DIAGRAM¹

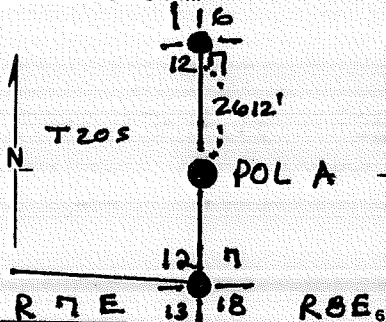

DESCRIBE CORNER MONUMENT FOUND

None Set

DESCRIBE BEARING TREES OR OTHER OFFICIAL ACCESSORIES FOUND

None Set

PHOTO IDENTIFICATION DATA

Photo No. _____

Filed At. _____

Object Ident. _____

Ident. By _____

Signature

DESCRIBE CORNER LOCATION RELATIVE TO NEAR-BY FEATURES, ALSO HOW TO REACH CORNER

2612' south ~~set~~ of $\frac{116}{12.7}$ Sect. Corner

PLANE COORDINATE POSITION DATA

State _____ Zone _____

X _____

Y _____

Estab. By _____

Agency

Signature

Walt Miller

Title
PLS

Division
CS

Headquarters
SO

Date

9/96

D-7100-52 (10/70)

CORNER RECORD (PERPETUATION)

MONUMENT: DESCRIBE NEW MONUMENT SET, OR WORK DONE TO PRESERVE EXISTING MONUMENT

Set By GPS Methods a capped rebar rising 2"

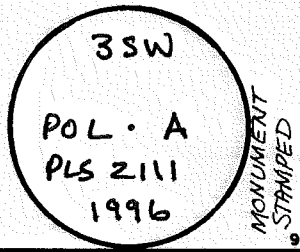

ACCESSORIES DESCRIBE NEW BT'S WITNESS OBJECTS ETC. ESTABLISHED, OR WORK DONE TO PRESERVE EXISTING EVIDENCE

11" Hemlock brs S.80°E @ 15.6' mkd 3SW POL.A BT
5" " " N77W @ 13.2' " X BT

10

Work Done By Walt Miller Title PLS Date 9/96 State Registration No. 2111
or Agency

Certified Cor. Record Prepared Yes No Filed At: Des. Court Date 2/27/97

REMARKS

12

Index File No. T. S., R. E., W. M. Tract or Surv. No. Cor. POL A

13

USDA-FOREST SERVICE

Three Sisters WA ~~22~~ Points

Index

CORNER RECORD (SEARCH)

Tract or

000983

Cor.

File No. _____

(Ref. FSM 7151.4)

Survey No. _____

No. POL B

T 20 S. R. 7 E.

R.D. Bend

County Deschutes

Merid. WILLAMETTE

N.F. DESCHUTES

State OREGON

CORNER DIAGRAM¹

T20S

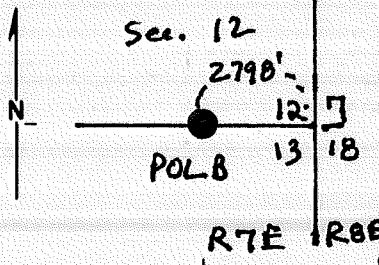

DESCRIBE CORNER MONUMENT FOUND

Not set

DESCRIBE BEARING TREES OR OTHER OFFICIAL ACCESSORIES FOUND

Not Set

PHOTO IDENTIFICATION DATA

Photo No. _____

Filed At. _____

Object Ident. _____

Ident. By _____

Signature

PLANE COORDINATE POSITION DATA

State _____ Zone _____

X _____

Y _____

Estab. By _____

Agency

DESCRIBE CORNER LOCATION RELATIVE TO NEAR-BY FEATURES, ALSO HOW TO REACH CORNER

2790' west of $\frac{12}{13} \frac{7}{18}$ Sec. Cor.

Signature Walt Miller

Title PLS

Division CS

Headquarters SO

Date 7/9/70 7100-52 (10/70)

CORNER RECORD (PERPETUATION)

MONUMENT: DESCRIBE NEW MONUMENT SET, OR WORK DONE TO PRESERVE EXISTING MONUMENT

Set By GPS methods a capped rebar rising 2"

3SW
POL. B
PLS 2111
1996

MONUMENT
STAMPED

ACCESSORIES: DESCRIBE NEW BT'S WITNESS OBJECTS ETC. ESTABLISHED, OR WORK DONE TO PRESERVE EXISTING EVIDENCE

5" Hemlock brs N 43° E @ 18.4' mfd 3SW POL B BT
4" " " S 18° W @ 22.0' " X BT

Work Done By Walt Miller Title PLS Date 9/96 State Registration No. 2111
or Agency

Certified Cor. Record Prepared? Yes No Filed At: Des. Co. Date 2/27/97

REMARKS

Index File No. T. S., R. E., W.M. Tract or Surv. No. 3SW Cor. POL B

USDA-FOREST SERVICE

Index

File No. _____

Three Sisters WA Points

CORNER RECORD (SEARCH)

(Ref. FSM 7151.4)

Tract or

Survey No. _____

000983

Cor.

No. _____

POL 2

T 20 S. R. 7 E.

R.D. _____

Bend

County _____

Deschutes

Merid. WILLAMETTE

N.F. _____

DESCHUTES

State _____

OREGON

CORNER DIAGRAM¹

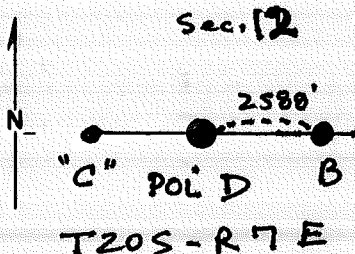

DESCRIBE CORNER MONUMENT FOUND

Not Set

DESCRIBE BEARING TREES OR OTHER OFFICIAL ACCESSORIES FOUND

Not Set

PHOTO IDENTIFICATION DATA

Photo No. _____

Filed At. _____

Object Ident. _____

Ident. By _____

Signature

PLANE COORDINATE POSITION DATA

State _____ Zone _____

X _____

Y _____

Estab. By _____

Agency

DESCRIBE CORNER LOCATION RELATIVE TO NEAR-BY FEATURES, ALSO HOW TO REACH CORNER

2588' west of POL B, Note! Plat indicates that these points are Not in alphabetical order.

Signature

Walt Miller

Title

PLS

Division

CS

Headquarters

SO

Date 9/96

7100-52 (10/78)

CORNER RECORD (PERPETUATION)

MONUMENT: DESCRIBE NEW MONUMENT SET, OR WORK DONE TO PRESERVE EXISTING MONUMENT

Set By GPS methods a capped rebar, rising 2"

3SW
POL. D
PLS 2111
1996
MONUMENT
STAMPED

ACCESSORIES DESCRIBE NEW BT'S WITNESS OBJECTS ETC. ESTABLISHED, OR WORK DONE TO PRESERVE EXISTING EVIDENCE

8" Hemlock brs S 49 E @ 22.3' mkd 3SW POL D BT
3" LPP " N 20° W @ 4.0' " X BT

Work Done By Walt Miller Title PLS Date 9/26 State Registration No. 2111
or Agency

Certified Cor. Record Prepared? Yes No Filed At: Des. Co. Date 2/27/97

REMARKS

Index File No. T. S., R. E., W.M. Tract or Surv. No. Cor. POL D

USDA-FOREST SERVICE

Index
File No. _____

Three Sisters WA Points
CORNER RECORD (SEARCH)
(Ref. FSM 7151.4)

Tract or Survey No. 000983 Cor. No. POL C

T 20 S. R. 7 E. R.D. Bend County Deschutes

Merid. WILLAMETTE N.F. DESCHUTES State OREGON

CORNER DIAGRAM

DESCRIBE CORNER MONUMENT FOUND

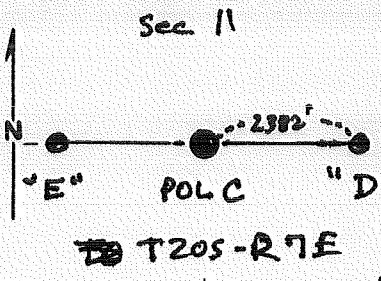

Not Set

DESCRIBE BEARING TREES OR OTHER OFFICIAL ACCESSORIES FOUND

Not Set

PHOTO IDENTIFICATION DATA

Photo No. _____
Filed At. _____
Object Ident. _____
Ident. By _____
Signature

DESCRIBE CORNER LOCATION RELATIVE TO NEAR-BY FEATURES, ALSO HOW TO REACH CORNER

2382' west of POL D - Capped points are
Not in alphabetical order.

PLANE COORDINATE POSITION DATA

State _____ Zone _____
X _____
Y _____
Estab. By _____
Agency

Signature Walt Miller

Title PLS Division es Headquarters so

Date 9/96 D-7100-52 (10/78)

USDA-FOREST SERVICE

Index

File No. _____

Three Sisters WA Points

CORNER RECORD (SEARCH)

(Ref. FSM 7151.4)

Tract or

Survey No.

000983

Cor. No. **POL C**

T 20 S. R. 7 E.

R.D. Bend

County Deschutes

Merid. WILLAMETTE

N.F. DESCHUTES

State OREGON

CORNER DIAGRAM¹

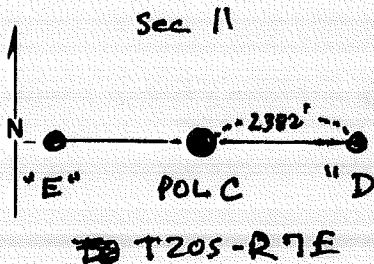

DESCRIBE CORNER MONUMENT FOUND

Not Set

DESCRIBE BEARING TREES OR OTHER OFFICIAL ACCESSORIES FOUND

Not Set

PHOTO IDENTIFICATION DATA

Photo No. _____

Filed At. _____

Object Ident. _____

Ident. By _____

Signature

PLANE COORDINATE POSITION DATA

State _____ Zone _____

X _____

Y _____

Estab. By _____

Agency

Signature

Walt Muller

Title

PLS

Division

es

Headquarters

so

Date

9/16 D-7100-52 (10/78)

CORNER RECORD (PERPETUATION)

MONUMENT: DESCRIBE NEW MONUMENT SET, OR WORK DONE TO PRESERVE EXISTING MONUMENT

Set by GPS methods a capped rebar rising 2"

3SW
POL • C
PLS 2111
1996
MONUMENT
STAMPED

ACCESSORIES DESCRIBE NEW BT'S WITNESS OBJECTS ETC. ESTABLISHED, OR WORK DONE TO PRESERVE EXISTING EVIDENCE

10" W. Fir brs S 32° W @ 11.2' MKD 3SW POL C BT
8" " " N 45° W @ 4.3' " X BT

Work Done By Walt Miller Title PLS Date 9/96 State Registration No. 2111
or Agency

Certified Cor. Record Prepared? Yes No Filed At: Des, Co. Date 2/23/97

REMARKS

Index File No. T. S., R. E., W.M. Tract or Surv. No. Cor. POL C

USDA-FOREST SERVICE

Index
File No. _____

T 20 S. R. 7 E.

Merid. WILLAMETTE

CORNER DIAGRAM¹

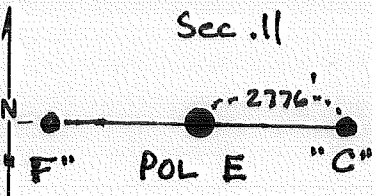

T20S R7E

PHOTO IDENTIFICATION DATA

Photo No. _____

Filed At. _____

Object Ident. _____

Ident. By _____

Signature

PLANE COORDINATE POSITION DATA

State _____ Zone _____

X _____

Y _____

Estab. By _____

Agency

Signature Walt Miller

Title PLS

Division CS

Headquarters SD

Date 9/16-7100-52 (10/78)

CORNER RECORD (SEARCH)
(Ref. FSM 7151.4)

Tract or
Survey No. 000983

Cor.
No. POL E

R.D. Bend County Deschutes

N.F. DESCHUTES State OREGON

DESCRIBE CORNER MONUMENT FOUND

Not Set

DESCRIBE BEARING TREES OR OTHER OFFICIAL ACCESSORIES FOUND

Not Set

DESCRIBE CORNER LOCATION RELATIVE TO NEAR-BY FEATURES, ALSO HOW TO REACH CORNER

2776' west of POL C - Capped Points are not in alphabetical order.

CORNER RECORD (PERPETUATION)

DESCRIBE NEW MONUMENT SET, OR WORK DONE TO PRESERVE EXISTING MONUMENT

using GPS methods a capped rebar rising 2"

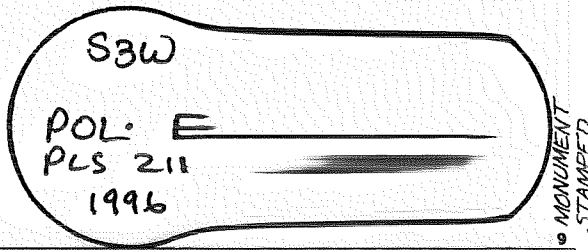

DESCRIBE NEW BT'S WITNESS OBJECTS ETC. ESTABLISHED, OR WORK DONE TO PRESERVE EXISTING EVIDENCE

P. pine brs S 14° W @ 5.8' mtd 3SW POL E BT
 W. Fir " N 70° W @ 14.0' " X BT

By Walt Miller Title PLS Date 9/96 State Registration No. 2111
 or Record Prepared? Yes No Filed At: Des. Co. Date 2/27/9

REMARKS

No. T. S., R. E., W.M. Tract or Surv. No. Cor. POL

USDA-FOREST SERVICE

Index

File No. _____

Three Sisters WA Points

CORNER RECORD (SEARCH)

(Ref. FSM 7151.4)

Tract or Survey No.

000983

Cor. No.

POL F

T 20 S. R. 7 E.

R.D. Bend

County Deschutes

Merid. WILLAMETTE

N.F. DESCHUTES

State OREGON

CORNER DIAGRAM

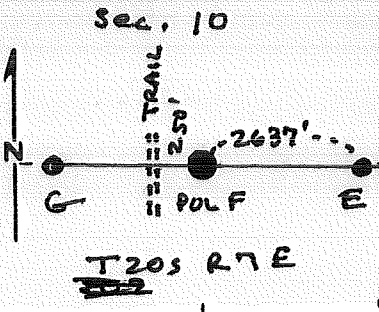

DESCRIBE CORNER MONUMENT FOUND

Not Set

DESCRIBE BEARING TREES OR OTHER OFFICIAL ACCESSORIES FOUND

Not Set

PHOTO IDENTIFICATION DATA

Photo No. _____

Filed At. _____

Object Ident. _____

Ident. By _____

Signature

7

PLANE COORDINATE POSITION DATA

State _____ Zone _____

X _____

Y _____

Estab. By _____

Agency

8

DESCRIBE CORNER LOCATION RELATIVE TO NEAR-BY FEATURES, ALSO HOW TO REACH CORNER

2637' "West" of POL E and ~250' east of trail (?) crossing.

Signature Walt Hubler

Title PLS

Division CS

Headquarters SO

Date 9/96

D-7100-52 (10/78)

5

CORNER RECORD (PERPETUATION)

MONUMENT: DESCRIBE NEW MONUMENT SET, OR WORK DONE TO PRESERVE EXISTING MONUMENT

Set using GPS methods, a capped rebar rising 6"

3SW
POL. F
PLS 2111
1996
MONUMENT
STAMPED

ACCESSORIES DESCRIBE NEW BT'S WITNESS OBJECTS ETC. ESTABLISHED, OR WORK DONE TO PRESERVE EXISTING EVIDENCE

10" Spruce brs N58°E @ 22.3' mtd 3SW POL F BT
6" W. Fir " N83°W @ 17.9' " X BT

Work Done By Walt Miller Title PLS Date 9/96 State Registration No. 2111
or Agency

Certified Cor. Record Prepared? Yes No Filed At: Des. County Date 2/27/97

REMARKS

Index File No. T. S., R. E., W. M. Tract or Surv. No. Cor. POL F

USDA-FOREST SERVICE

Index

File No. _____

Three Sisters WA Points

CORNER RECORD (SEARCH)

(Ref. FSM 7151.4)

Tract or

Survey No. _____

Cor. No. _____

POL G

T 20 S. R. 7 E.

R.D. Bend

County Deschutes

Merid. WILLAMETTE

N.F. DESCHUTES

State OREGON

CORNER DIAGRAM

Sec 9/10

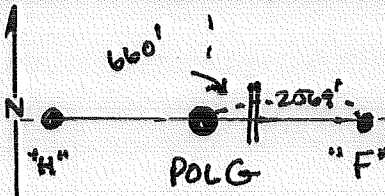

T 20 S R 7 E

DESCRIBE CORNER MONUMENT FOUND

Not Set

DESCRIBE BEARING TREES OR OTHER OFFICIAL ACCESSORIES FOUND

Not Set

PHOTO IDENTIFICATION DATA

Photo No. _____

Filed At. _____

Object Ident. _____

Ident. By _____

Signature

PLANE COORDINATE POSITION DATA

State _____ Zone _____

X _____

Y _____

Estab. By _____

Agency

DESCRIBE CORNER LOCATION RELATIVE TO NEAR-BY FEATURES, ALSO HOW TO REACH CORNER

2569' "West" of POL F and ~660' ~~east~~ West of Trail(?)

Signature

Walt Miller

Title

PLS

Division

CS

Headquarters

SO

Date

9/96-7100-52 (10/78)

CORNER RECORD (PERPETUATION)

MONUMENT: DESCRIBE NEW MONUMENT SET, OR WORK DONE TO PRESERVE EXISTING MONUMENT

Set using GPS methods a capped rebar rising 2"

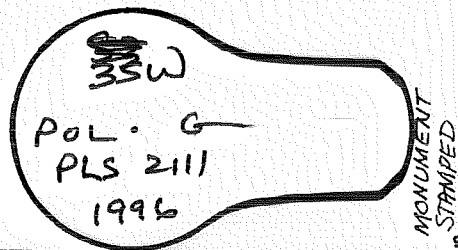

ACCESSORIES DESCRIBE NEW BT'S WITNESS OBJECTS ETC. ESTABLISHED, OR WORK DONE TO PRESERVE EXISTING EVIDENCE

10" L. fine brs N 21° E @ 39.9' mkd 3SW POL G BT
 4" " " S 18° E @ 35.0' " X BT

Work Done By Walt Muller Title PLS Date 9/96 State Registration No. 2111
 or Agency

Certified Cor. Record Prepared? Yes No Filed At: Dee, Co. Date 2/27/9

REMARKS

Index File No. T. S., R. E., W. M. Tract or Surv. No. 3SW Cor. POL

USDA-FOREST SERVICE

Index

File No. _____

Three Sisters WA Points

CORNER RECORD (SEARCH)

(Ref. FSM 7151.4)

Tract or

Survey No. _____

000983

Cor. No.

POL G

T 20 S. R. 7 E. R.D. Bend

R.D. Bend

County Deschutes

County Deschutes

Merid. WILLAMETTE

N.F. DESCHUTES

State OREGON

State OREGON

CORNER DIAGRAM

Sec 9/10

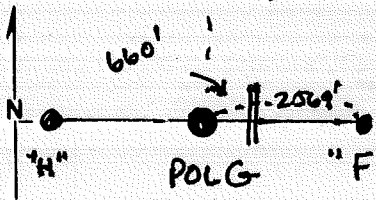

T 20 S R 7 E

DESCRIBE CORNER MONUMENT FOUND

Not Set

DESCRIBE BEARING TREES OR OTHER OFFICIAL ACCESSORIES FOUND

Not Set

PHOTO IDENTIFICATION DATA

Photo No. _____

Filed At. _____

Object Ident. _____

Ident. By _____

Signature

PLANE COORDINATE POSITION DATA

State _____ Zone _____

X _____

Y _____

Estab. By _____

Agency

DESCRIBE CORNER LOCATION RELATIVE TO NEAR-BY FEATURES, ALSO HOW TO REACH CORNER

2569' "West" of POL F and ~660' ~~east of~~ West of Trail(?)

Signature

Walt Miller

Title

PLS

Division

CS

Headquarters

SO

Date

9/98-7100-52 (10/78)

CORNER RECORD (PERPETUATION)

MONUMENT: DESCRIBE NEW MONUMENT SET, OR WORK DONE TO PRESERVE EXISTING MONUMENT

Set using GPS methods a capped rebar rising 2"

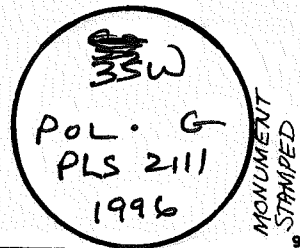

ACCESSORIES: DESCRIBE NEW BT'S WITNESS OBJECTS ETC. ESTABLISHED, OR WORK DONE TO PRESERVE EXISTING EVIDENCE

10" L. pine brs N 21° E @ 39.9' mkd 3SW POL G BT
4" " " S 18° E @ 35.0' " X BT

Work Done By Walt Muller Title PLS Date 9/96 State Registration No. 2111
or Agency

Certified Cor. Record Prepared? Yes No Filed At: Dec. Co. Date 2/27/97

REMARKS

Index File No. T. S., R. E., W. M. Tract or Surv. No. 3SW Cor. POL G-13

USDA-FOREST SERVICE

Index

File No. _____

Three Sisters WA Point

CORNER RECORD (SEARCH)

(Ref. FSM 7151.4)

Tract or

Survey No.

000983

Cbr.

No. POL H

T 20 S. R. 7 E.

R.D. Bend

County Deschutes

Merid. WILLAMETTE

N.F. DESCHUTES

State OREGON

CORNER DIAGRAM

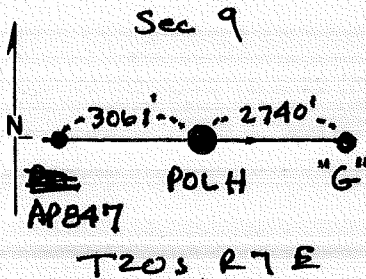

DESCRIBE CORNER MONUMENT FOUND

Not Set

DESCRIBE BEARING TREES OR OTHER OFFICIAL ACCESSORIES FOUND

Not Set

PHOTO IDENTIFICATION DATA

Photo No. _____

Filed At. _____

Object Ident. _____

Ident. By _____

Signature

PLANE COORDINATE POSITION DATA

State _____ Zone _____

X _____

Y _____

Estab. By _____

Agency

DESCRIBE CORNER LOCATION RELATIVE TO NEAR-BY FEATURES, ALSO HOW TO REACH CORNER

2740' "West" of POL G and 3061' "East" of AP 847.

Signature

Walt Muller

Title

PLS

Division

CS

Headquarters

SO

Date

9/96

D-7100-52 (10/78)

CORNER RECORD (PERPETUATION)

MONUMENT DESCRIBE NEW MONUMENT SET, OR WORK DONE TO PRESERVE EXISTING MONUMENT

Set using GPS methods a capped rebar rising 2"

3SW
POL. H
PLS 2111
1996
MONUMENT
STRAPPED

ACCESSORIES DESCRIBE NEW BT'S WITNESS OBJECTS ETC. ESTABLISHED, OR WORK DONE TO PRESERVE EXISTING EVIDENCE

4" L. P. Pine brs S 50°W @ 5.2' MKd XBT

14" W. Fir " N 11°W @ 36.2' " @ 3SW POL H BT

Work Done By Walt Miller Title PLS Date 9/96 State Registration No. 2111
or Agency

Certified Cor. Record Prepared? Yes No Filed At: Dep. Co. Date 2/27/97

REMARKS

Index File No. T. S., R. E., W. M. Tract or Surv. No.

Cor. POL H

USDA-FOREST SERVICE

Index

File No. _____

Three Sisters WA Points

CORNER RECORD (SEARCH)

(Ref. FSM 7151.4)

Tract or

000983

Survey No.

Cor.

No.

AP 847

T 20 S. R. 7 E.

R.D. Band

County Deschutes

Merid. WILLAMETTE

N.F. DESCHUTES

State OREGON

CORNER DIAGRAM¹

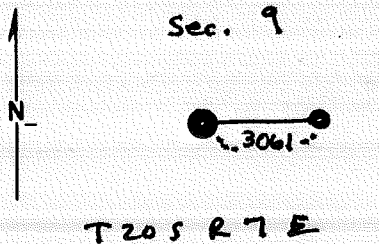

DESCRIBE CORNER MONUMENT FOUND

Not Set

DESCRIBE BEARING TREES OR OTHER OFFICIAL ACCESSORIES FOUND

Not Set

PHOTO IDENTIFICATION DATA

Photo No. _____

Filed At. _____

Object Ident. _____

Ident. By _____

Signature

PLANE COORDINATE POSITION DATA

State _____ Zone _____

X _____

Y _____

Estab. By _____

Agency

DESCRIBE CORNER LOCATION RELATIVE TO NEAR-BY FEATURES, ALSO HOW TO REACH CORNER

3061' "west" of POL H

Signature Walt Miller

Title PLS

Division CS

Headquarters SO

Date 9/96

D-7100-52 (10/78)

CORNER RECORD (PERPETUATION)

MONUMENT: DESCRIBE NEW MONUMENT SET, OR WORK DONE TO PRESERVE EXISTING MONUMENT

Set using GPS methods a capped rebar rising 2"

3SW
AP . 847
PLS 2111
1996
MONUMENT STAMPED

ACCESSORIES DESCRIBE NEW BT'S WITNESS OBJECTS ETC. ESTABLISHED, OR WORK DONE TO PRESERVE EXISTING EVIDENCE

12" Hemlock ^{brs} S 32° E @ 28.9' mk X BT
8" " brs N 60° W @ 37.2' " 3SW AP 847 BT

Work Done By Walt Miller Title PLS Date 9/96 State Registration No. 2111 or Agency

Certified Cor. Record Prepared? Yes No Filed At: Des. Co. Date 2/27/97

REMARKS

Index File No.

T.

S., R.

E., W.M.

Tract or Surv. No.

Cor. AP 847